

Jeux de mors standard

18013/xx P20; FP20

Pno	gamme	D	L
*18013/10	10.0...12.0	10	55
*18013/12	12.0...14.0	12	55
*18013/14	14.0...16.0	14	55
18013/16	16.0...19.0	16	55
18013/19	19.0...23.0	19	55
18013/23	23.0...27.0	23	55
18013/27	27.0...31.0	27	70
18013/31	31.0...36.0	31	70
*18013/36	36.0...41.0	36	75
*18013/41	41.0...47.0	41	75
*18013/47	47.0...54.0	47	85
*18013/54	54.0...61.0	54	85

18013/xxL FP20

18013/16L	16.0...19.0	16	75
18013/19L	19.0...23.0	19	75
18013/23L	23.0...27.0	23	75
18013/27L	27.0...31.0	27	75
18013/31L	31.0...36.0	31	75

matrices avec *

405060/xxx FP170

Pno	gamme	D	L
405060/205	205.0...220.0	205	220
405060/220	220.0...235.0	220	220
405060/235	235.0...250.0	235	220
405060/250	250.0...270.0	250	220
405060/270	270.0...290.0	270	220
405060/290	290.0...320.0	290	220

18852/xx FP160

Pno	gamme	D	L
18852/84	84.0 - 92.0	84	116
18852/92	92.0 - 100.0	92	116
18852/100	100.0 - 108.0	100	116
18852/108	108.0 - 116.0	108	116
18852/116	116.0 - 126.0	116	116
18852/126	126.0 - 136.0	126	116
18852/136	136.0 - 146.0	136	116
18852/146	146.0 - 156.0	146	116
18852/156	156.0 - 166.0	156	116
18852/166	166.0 - 178.0	166	116
18852/178	178.0 - 190.0	178	116
18852/190	190.0 - 202.0	190	116

18546/xx CC20, NC20

Pno	gamme	D	L
18546/12	12.0 - 16.0	12	3
18546/16	16.0 - 22.0	16	4
18546/22	22.0 - 27.0	22	4.5
18546/27	27.0 - 34.0	27	5
18546/34	34.0 - 41.0	34	5
18546/41	41.0 - 49.0	41	5

SEIHP

18212/xx P16

Pno	gamme	D	L
18212/10	10.0 - 12.0	10	55
18212/12	12.0 - 14.0	12	55
18212/14	14.0 - 16.0	14	55
18212/16	16.0 - 19.0	16	55
18212/19	19.0 - 23.0	19	55
18212/23	23.0 - 27.0	23	55
18212/27	27.0 - 31.0	27	65
18212/31	31.0 - 38.0	31	65

18860/xx FP140

Pno	gamme	D	L
18860/84	84.0 - 92.0	84	110
18860/92	92.0 - 100.0	92	110
18860/100	100.0 - 108.0	100	110
18860/108	108.0 - 116.0	108	110
18860/116	116.0 - 124.0	116	110

18860/xxL FP145

18860/84L	84.0...92.0	84	120
18860/92L	92.0...100.0	92	120
18860/100L	100.0...108.0	100	120
18860/108L	108.0...116.0	108	120
18860/116L	116.0...124.0	116	120

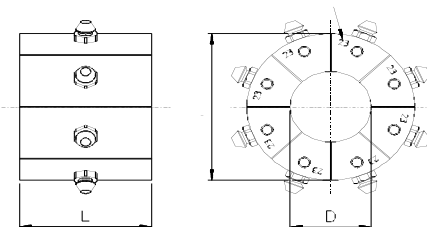

18859/xx NC30

Pno	gamme	D	L
18859/12	12.0 - 14.0	12	3
18859/14	14.0 - 16.0	14	3
18859/16	16.0 - 19.0	16	4
18859/19	19.0 - 22.0	19	4
18859/22	22.0 - 26.0	22	4.5
18859/26	26.0 - 30.0	26	4.5
18859/30	30.0 - 34.0	30	5
18859/34	34.0 - 39.0	34	5
18859/39	39.0 - 45.0	39	5
18859/45	45.0 - 51.0	45	5
18859/51	51.0 - 57.0	51	5
18859/57	57.0 - 63.0	57	5
18859/63	63.0 - 69.0	63	5
18859/69	69.0 - 73.0	69	5
18859/73	73.0 - 78.0	73	5

Finn-Power

18506/xx P32

Pno	gamme	D	L
*18506/10	10.0...12.0	10	55
*18506/12	12.0...14.0	12	55
*18506/14	14.0...16.0	14	55
*18506/16	16.0...19.0	16	55
*18506/19	19.0...22.0	19	55
*18506/22	22.0...26.0	22	70
*18506/26	26.0...30.0	26	70
*18506/30	30.0...34.0	30	70
*18506/34	34.0...39.0	34	75
*18506/39	39.0...45.0	39	75
*18506/45	45.0...51.0	45	90
*18506/51	51.0...57.0	51	90
*18506/57	57.0...63.0	57	100
18506/63	63.0...69.0	63	110
18506/69	69.0...75.0	69	110
18506/74	74.0...80.0	74	110
18506/78	78.0...87.0	78	110

18506/xxL FP145

18506/63L	63.0...69.0	63	120
18506/69L	69.0...75.0	69	120
18506/74L	74.0...80.0	74	120
18506/78L	78.0...87.0	78	120

matrices avec *

18315/xx Modèle CC22, SP

Pno	gamme	D	L
18315/10	10.0...12.0	10	50
18315/12	12.0...14.0	12	50
18315/14	14.0...16.0	14	50
18315/16	16.0...19.0	16	50
18315/19	19.0...23.0	19	50
18315/23	23.0...27.0	23	50
18315/27	27.0...31.0	27	50
18315/31	31.0...36.0	31	50
18315/36	36.0...41.0	36	50
18315/41	41.0...47.0	41	50
18315/47	47.0...54.0	47	50

702044/xx NC30

Pno	gamme	D	L
702044/12	12.0 - 14.0	12	3
702044/14	14.0 - 16.0	14	3
702044/16	16.0 - 19.0	16	4
702044/19	19.0 - 22.0	19	4
702044/22	22.0 - 26.0	22	4.5
702044/26	26.0 - 30.0	26	4.5
702044/30	30.0 - 34.0	30	5
702044/34	34.0 - 39.0	34	5
702044/39	39.0 - 45.0	39	5
702044/45	45.0 - 51.0	45	5
702044/51	51.0 - 57.0	51	5
702044/57	57.0 - 63.0	57	5